

610 Central

Shopping Center

Albuquerque, NM - Downtown
Southwest corner of Central Ave. & 6th Street



Available

- Restaurant, Retail, or Office space

Features

- Parking available across the street: over 100 controlled parking spaces
- Some existing restaurant build out
- Densely populated residential, office, and entertainment area
- HUB Zone qualified location



Demographics

	<u>1 Mile</u>	<u>3 Mile</u>	<u>5 Mile</u>
Population	14,812	96,315	239,098
Med. Income	\$28,241	\$33,381	\$39,582
Day Population	36,017	106,694	203,739

Contact Matt Reeves, 505.884.3578
Matt@PetersonProperties.net



610 Central



Retail, Restaurant or Office Space

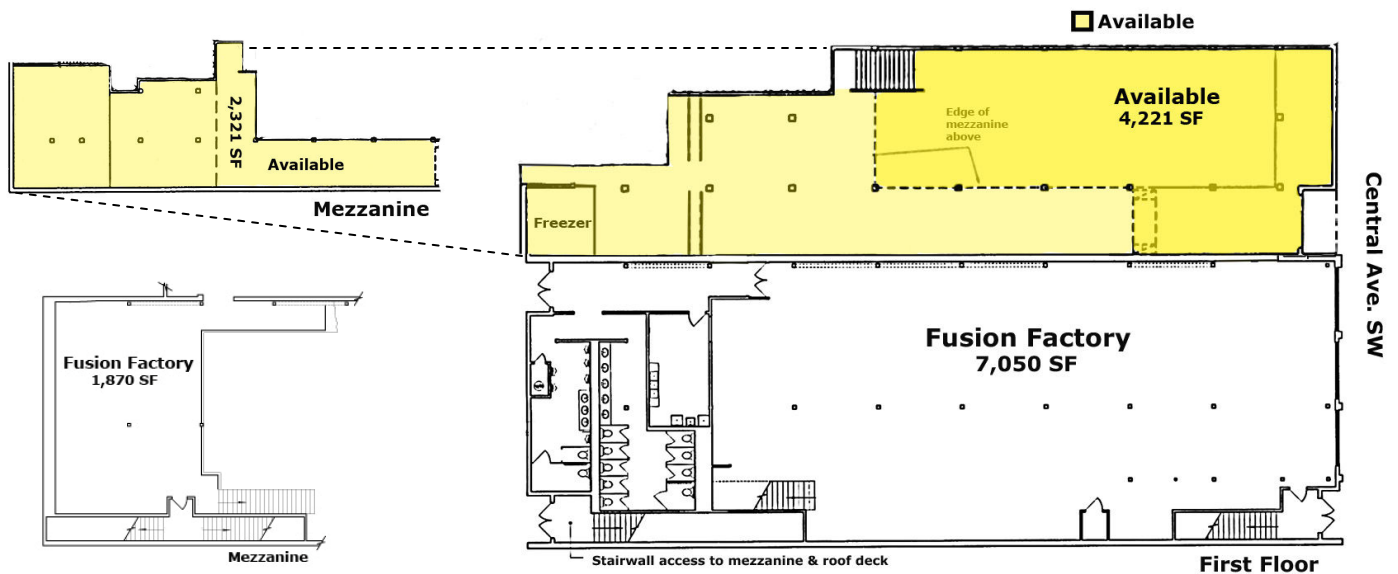

Contact Matt Reeves, 505.884.3578
Matt@PetersonProperties.net