

# Louisiana Plaza

## Shopping Center

**Albuquerque, NM**

**Southeast Corner of Montgomery & Louisiana**



### Available

- Retail or Restaurant
- 1,525 SF or 17,550 SF
- \$3,150 or \$26,775/Month
- Can be subdivided

### Features

- 2 Marquees on Montgomery
- Free standing Electronic Reader Board
- Anchored by Smith's, T.J. Maxx, Weems Gallery & Petsense
- 37,700 Cars / Day on Montgomery  
15,600 Cars / Day on Louisiana

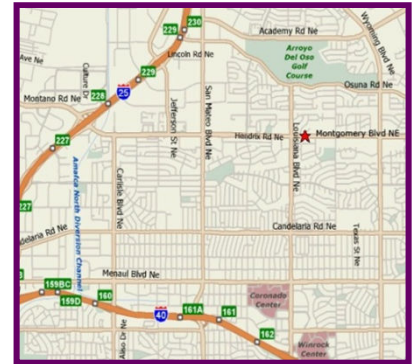

### Demographics

	<u>1 Mile</u>	<u>3 Mile</u>	<u>5 Mile</u>
Population	16,038	132,282	303,119
Med. Income	\$48,569	\$47,033	\$46,514
Day Population	6,140	87,094	208,074

**Contact Jazmin Godoy, 505.884.3578**

**Jazmin@PetersonProperties.net**



[www.PetersonProperties.net](http://www.PetersonProperties.net)  
 7200 Montgomery Blvd NE | Albuquerque, NM 87109

# Louisiana Plaza

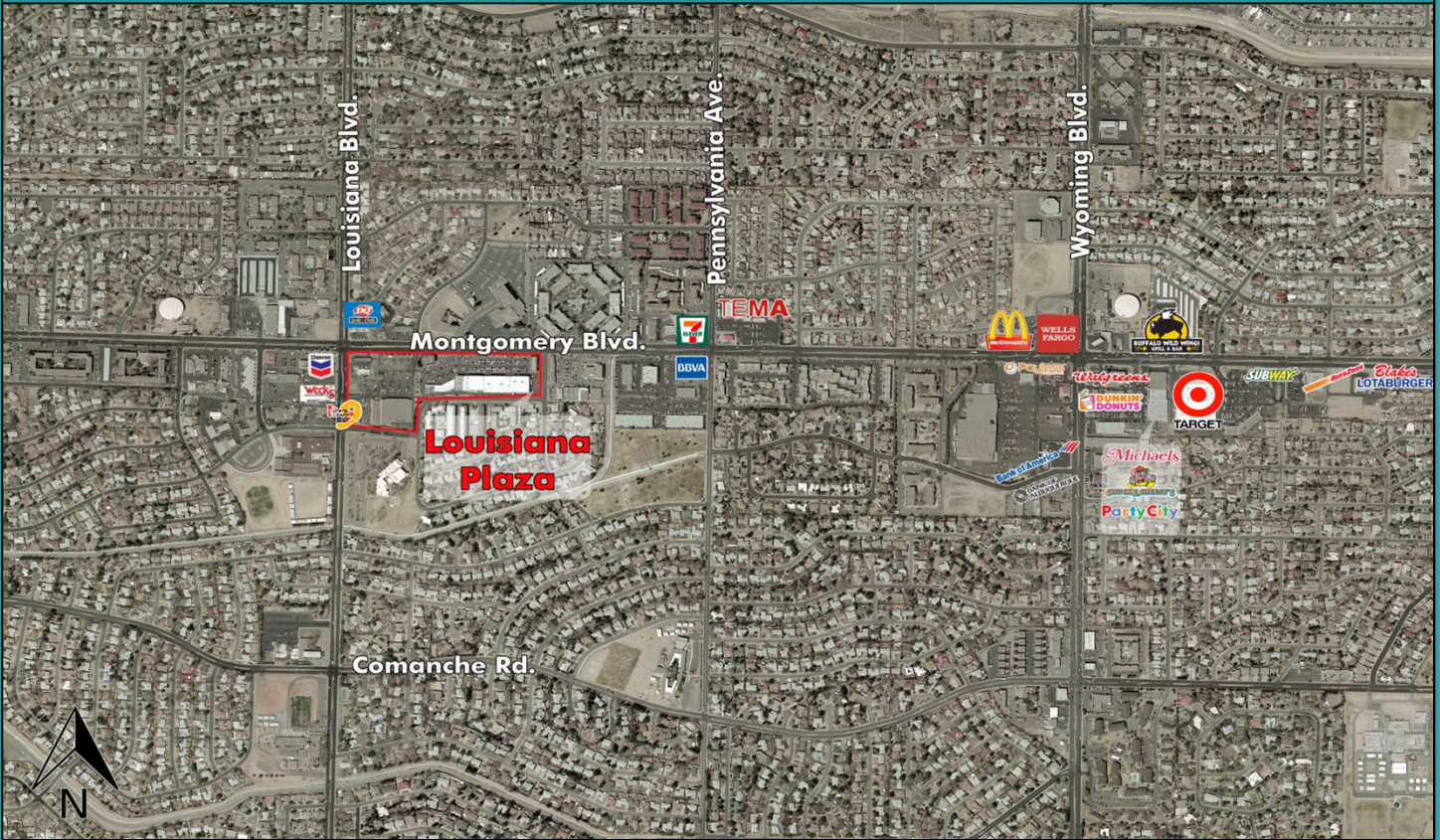

## Retail or Restaurant Space

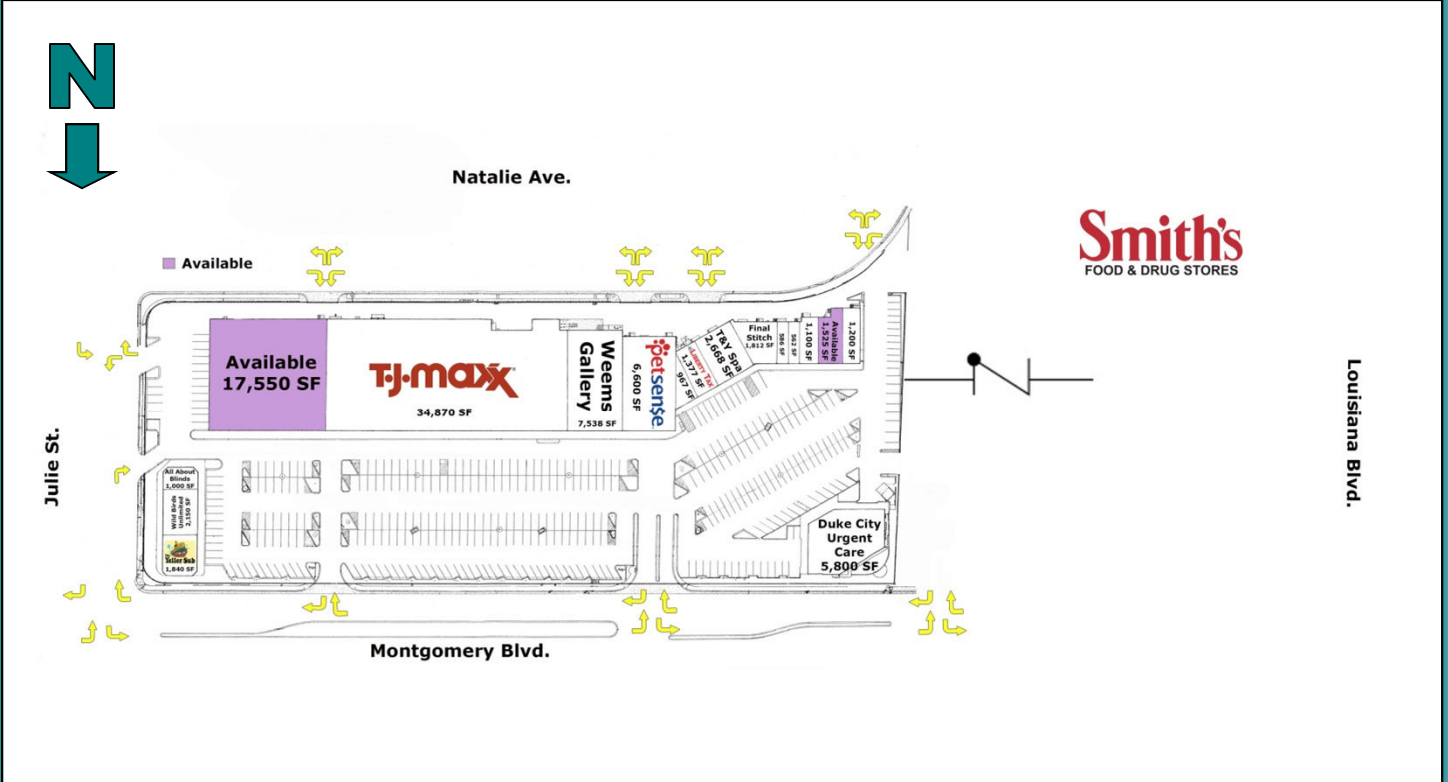

Contact Jazmin Godoy, 505.884.3578  
Jazmin@PetersonProperties.net