



Northeast corner of Lomas & 6th NW

Commercial Space

Albuquerque, NM - Downtown
523 Lomas Blvd. NW



Available

- 100% occupied



Huge Surrounding Population



Central Business District



HUB Zone qualified location

Please contact us for leasing opportunities

Demographics

1 Mile

3 mile

5 mile

	1 Mile	3 mile	5 mile
Population	12,955	94,691	246,355
Med. Income	\$39,077	\$42,179	\$44,971
Day Population	53,394	119,493	221,812

Surroundings Info

- Close to Courthouses & City Hall.
- Free Standing Building.
- High Visibility.
- Locally owned and managed.



Contact

Vanessa Valadez
 505.884.3578
 Vanessa@PetersonProperties.net

PetersonProperties.net
 /petersonpropertiesllc
 /petersonpropertiesllc
 /peterson.properties





Site Plan



Please contact us for leasing opportunities

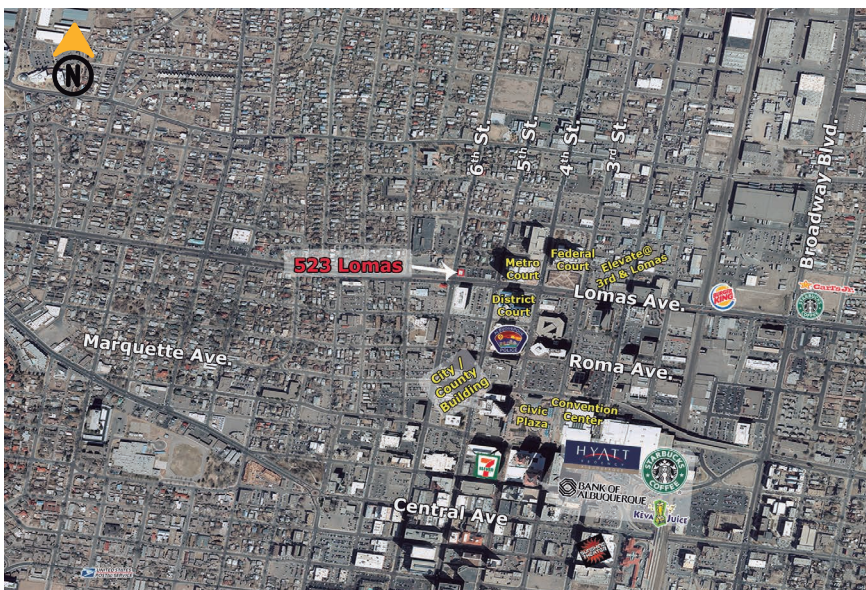

Aerial Map

523 Lomas Blvd NW Albuquerque, NM

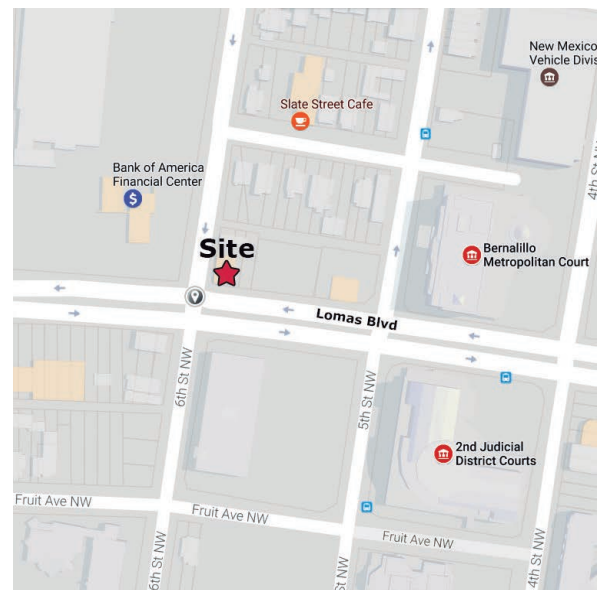

Contact us



 Vanessa Valadez

 505.884.3578

 Vanessa@PetersonProperties.net

