

### Albuquerque

4000 Menaul Blvd. NE



 Demographics	1 Mile	3 mile	5 mile
Population	14,591	115,378	292,117
Med. Income	\$45,293	\$43,496	\$47,047
Day Population	13,436	103,154	249,362

Please contact us for leasing opportunities

#### Available



- Commercial Space
- 1,870 SF | \$2,095/Month

#### Surroundings Info

- Excellent location in the Uptown area.
- Prominent signage along Menaul.
- Easy access to and from I-40.
- Locally owned and managed.



#### Contact

 Vanessa Valadez  
 505.884.3578  
 Vanessa@PetersonProperties.net

 [PetersonProperties.net](http://PetersonProperties.net)  
 /petersonpropertiesllc  
 /petersonpropertiesllc  
 /peterson.properties



### Site Plan

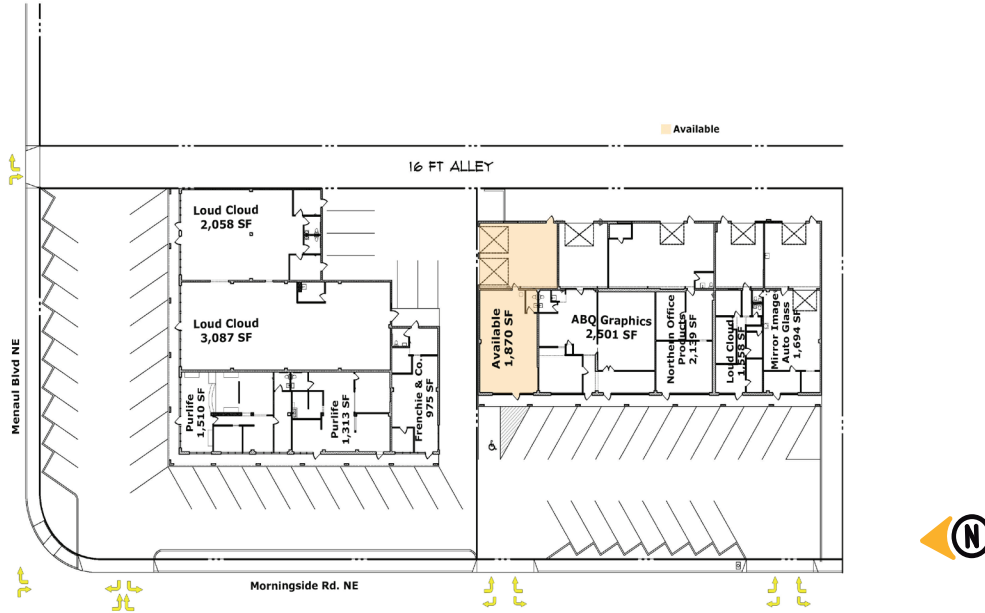

**Please contact us for leasing opportunities**



### Aerial Map



### 4000 Menaul Blvd. NE Albuquerque, NM 87110

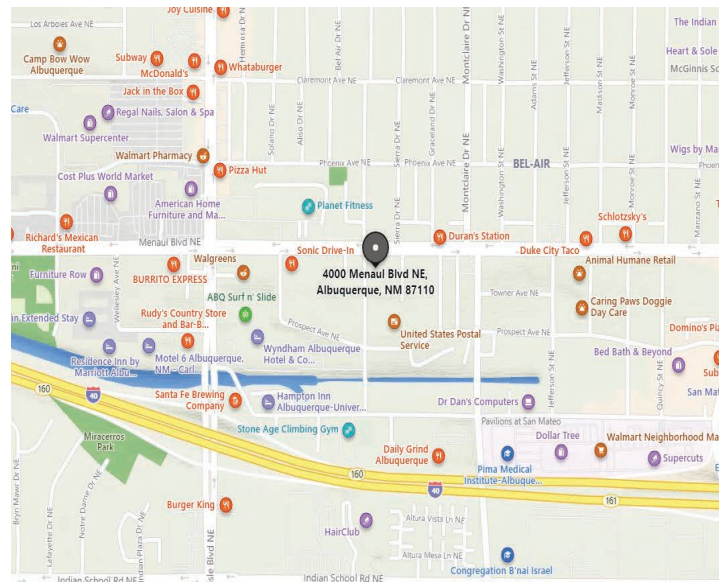
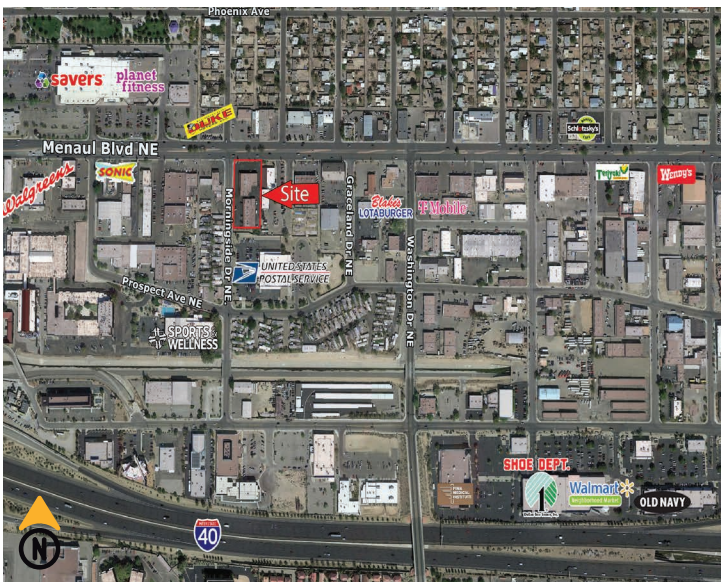

### Contact us



 Vanessa Valadez

 505.884.3578

 [Vanessa@PetersonProperties.net](mailto:Vanessa@PetersonProperties.net)

