



5115 Copper NE

Office, Retail or Service Building

Albuquerque
5115 Copper Ave. NE



Demographics	1 Mile	3 mile	5 mile
Population	14,222	115,430	262,930
Med. Income	\$43,165	\$38,892	\$42,679
Day Population	12,955	98,058	221,606

Please contact us for leasing opportunities

Available

- Commercial + Executive Office Space
- Suite A-E | 145 SF - 265 SF | \$170 - \$290/Month
- 5115 Copper + 207 Truman | 4,869 SF
\$4,990/Month

Features

- Easy access to and from I-40.
- Excellent street exposure.
- Cannabis friendly.
- Locally owned and managed.
- Free Wi-Fi (Suites A-E).



Contact

Brighton Pope
 505.884.3578
 Brighton.Pope@PetersonProperties.net

PetersonProperties.net
 /petersonpropertiesllc
 /petersonpropertiesllc
 /peterson.properties



Site Plan

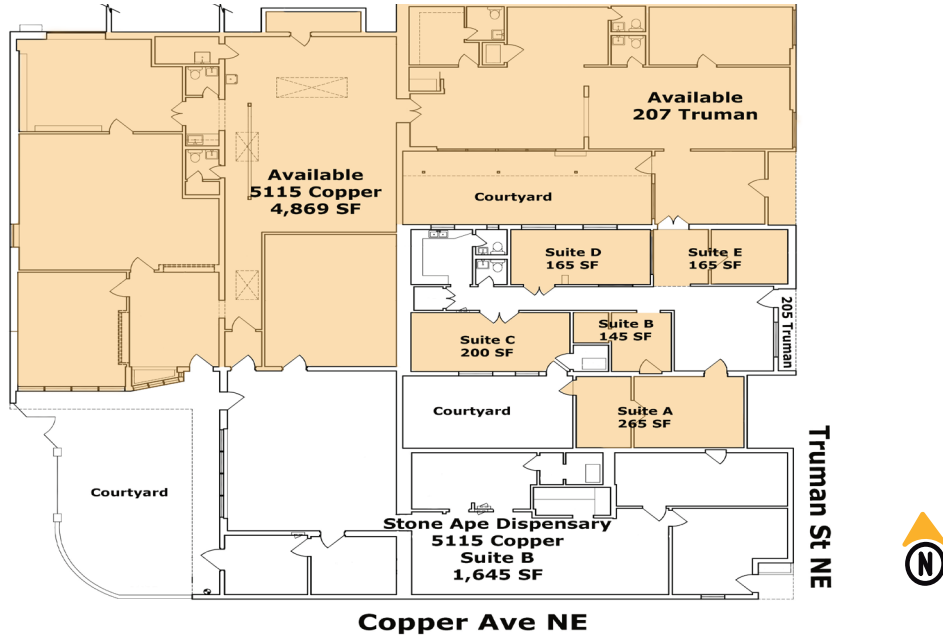

Please contact us for leasing opportunities



Aerial Map

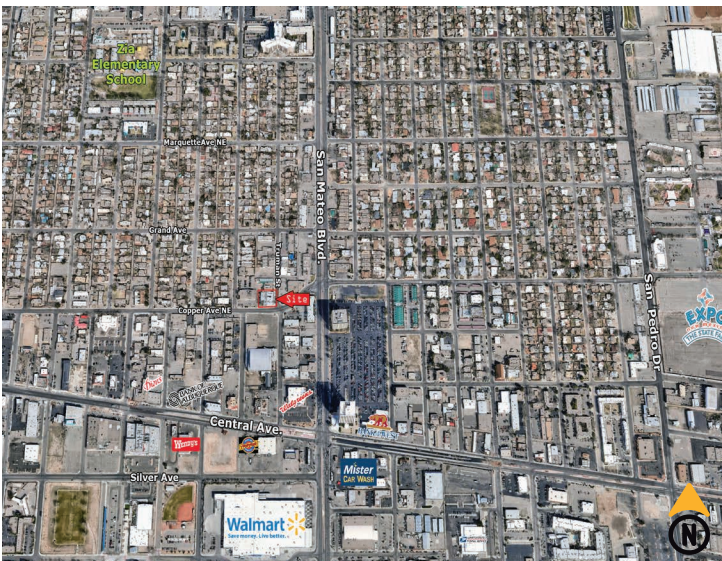

5115 Copper Ave. NE Albuquerque, NM 87110

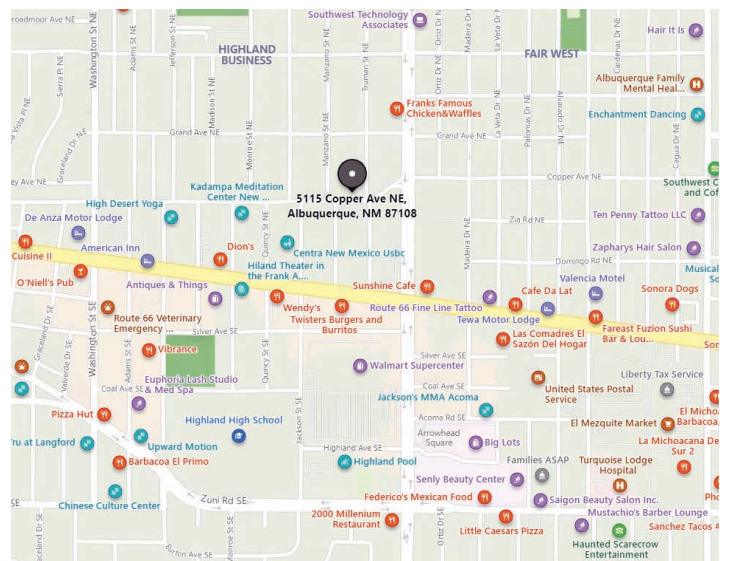

Contact us
 Brighton Pope | 505.884.3578 | Brighton.Pope@PetersonProperties.net

