



# Central & 12th

## Commercial Space

Albuquerque, NM - Downtown  
1121, 1123 & 1125 Kent Avenue NW



**Huge Surrounding  
Population**



**New Parking Lot**



**Active Nightlife  
Area**



**HUB Zone  
qualified location**

**Please contact us for leasing opportunities**

### **Demographics**

	1 Mile	3 mile	5 mile
Population	12,327	98,038	248,046
Med. Income	\$35,393	\$34,510	\$39,299
Day Population	35,565	110,677	204,126

### **Surroundings Info**

- High Visibility.
- Free WiFi + Secure Access.
- Locally owned and managed.
- Food Truck Parking Available.



#### **Contact**

 Brighton Pope  
 505.884.3578  
 Brighton.Pope@PetersonProperties.net

 **PetersonProperties.net**  
 /petersonpropertiesllc  
 /petersonpropertiesllc  
 /peterson.properties



### Site Plan

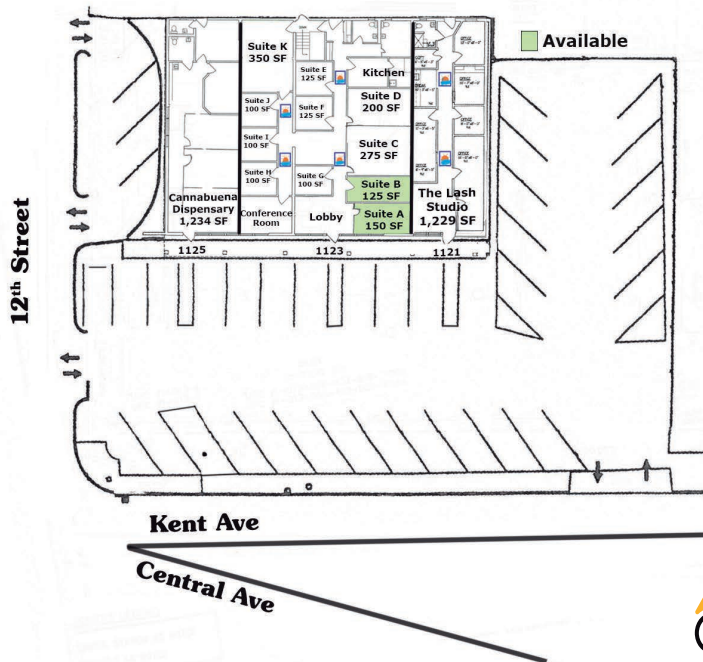

### Available

- Suite 1123A | 150 SF | \$330/Mo
- Suite 1123B | 125 SF | \$275/Mo

Please contact us for leasing opportunities

### Aerial Map

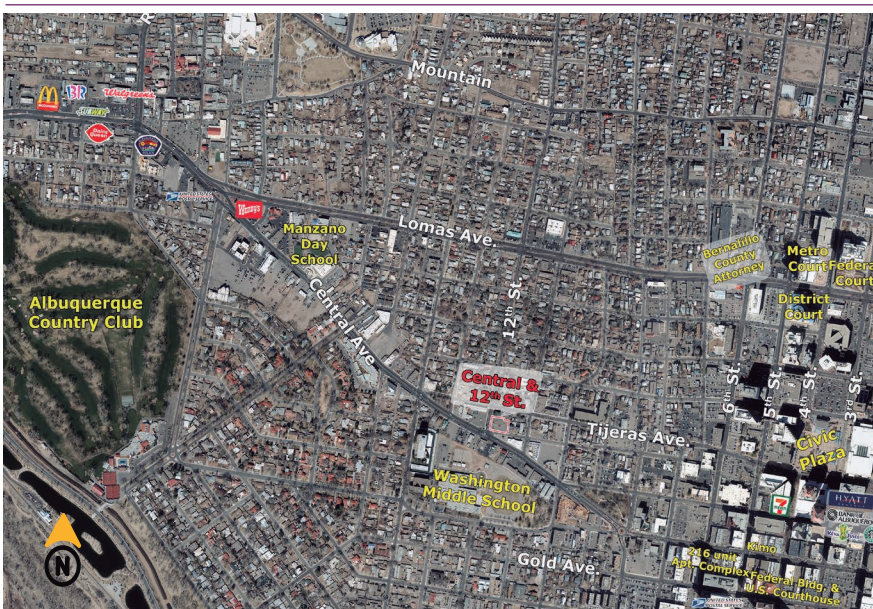

### 1121, 1123 & 1125 Kent Ave. NW Albuquerque, NM



### Contact us



Brighton Pope

505.884.3578

Brighton.Pope@PetersonProperties.net

