



# Quickel Complex

Retail, Office & Restaurant Spaces at the Southwest corner of Central Ave. & 6<sup>th</sup> Street as well as the Northwest corner of Gold Ave. & 6<sup>th</sup> Street

## Albuquerque, NM - Downtown 600 Central Avenue SW & 609 Gold Avenue SW



**Huge Surrounding  
Population**



**Parking Lot  
Across Street**



**Active Nightlife  
Area**



**HUB Zone  
qualified location**

**Please contact us for leasing opportunities**



### Available

#### **600 Central SW**

- Suite 105 | 1,100 SF  
\$1,250/Month

#### **609 Gold SW**

- Suite 1G | 475 SF  
\$475/Month
- Suite 1J | 200 SF  
\$225/Month
- Suite 2B | 585 SF  
\$475/Month



### Surroundings Info

- Free surface parking included.
- Full kitchen at 609 Gold + Free WiFi.
- Grocery Store at Silver Ave & 3<sup>rd</sup>.
- Anchored by Boese Bros. Brewing.
- Locally owned and managed.



#### **Contact**

● Brighton Pope  
● 505.884.3578  
● Brighton.Pope@PetersonProperties.net

● **PetersonProperties.net**  
● /petersonpropertiesllc  
● /petersonpropertiesllc  
● /peterson.properties

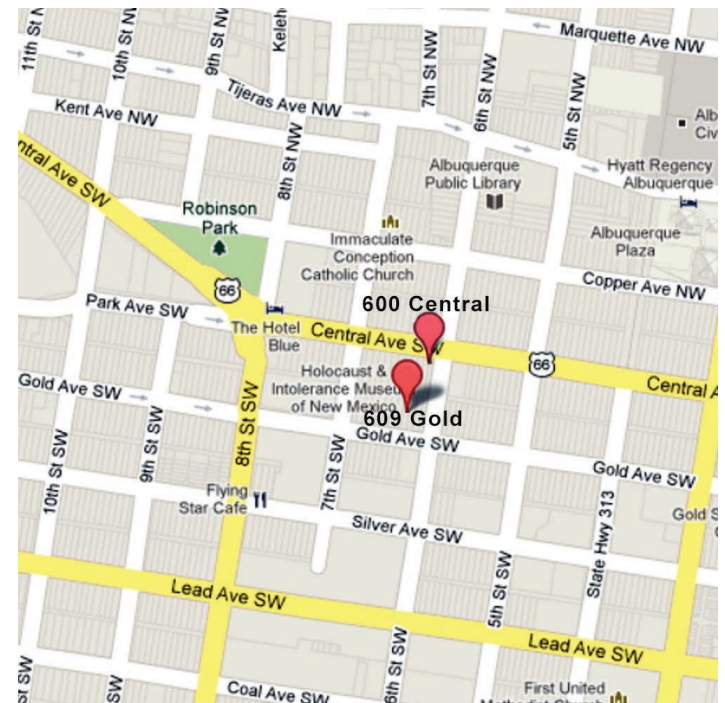
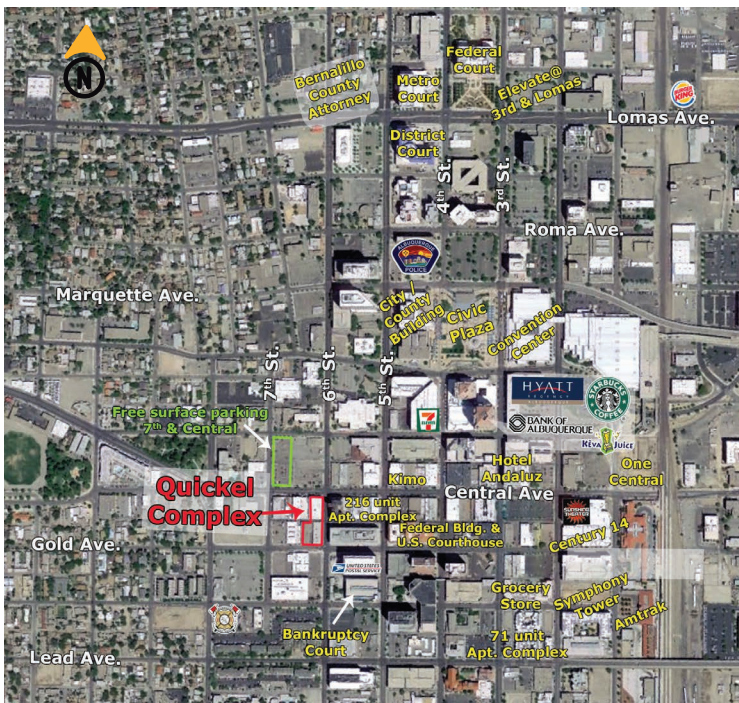
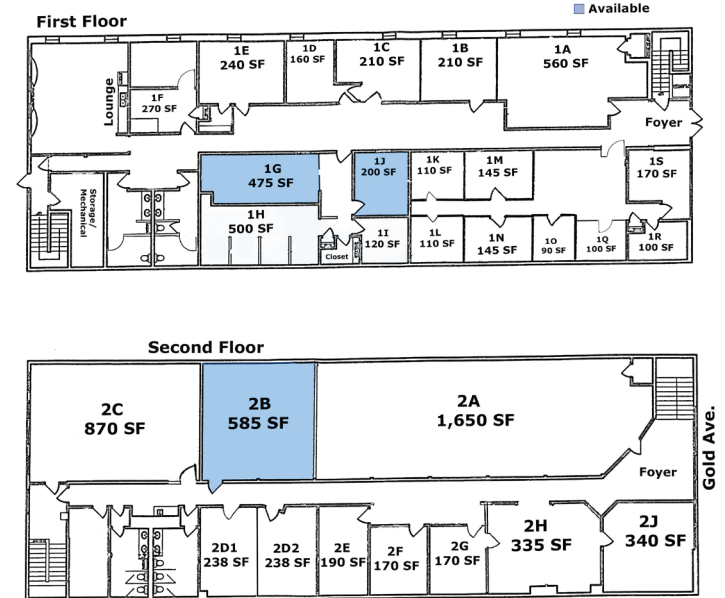

## Contact us

 Brighton Pope |  505.884.3578 |  Brighton.Pope@PetersonProperties.net

