



Central & 12th

Commercial Space

Albuquerque, NM - Downtown
1121, 1123 & 1125 Kent Avenue NW



Huge Surrounding
Population



New Parking Lot



Active Nightlife
Area



HUB Zone
qualified location

Please contact us for leasing opportunities

Demographics

	1 Mile	3 mile	5 mile
Population	12,327	98,038	248,046
Med. Income	\$35,393	\$34,510	\$39,299
Day Population	35,565	110,677	204,126

Surroundings Info

- High Visibility.
- Free WiFi + Secure Access.
- Locally owned and managed.
- Food Truck Parking Available.



Contact

 Brighton Pope
 505.884.3578
 Brighton.Pope@PetersonProperties.net

 PetersonProperties.net
 /petersonpropertiesllc
 /petersonpropertiesllc
 /peterson.properties

Site Plan

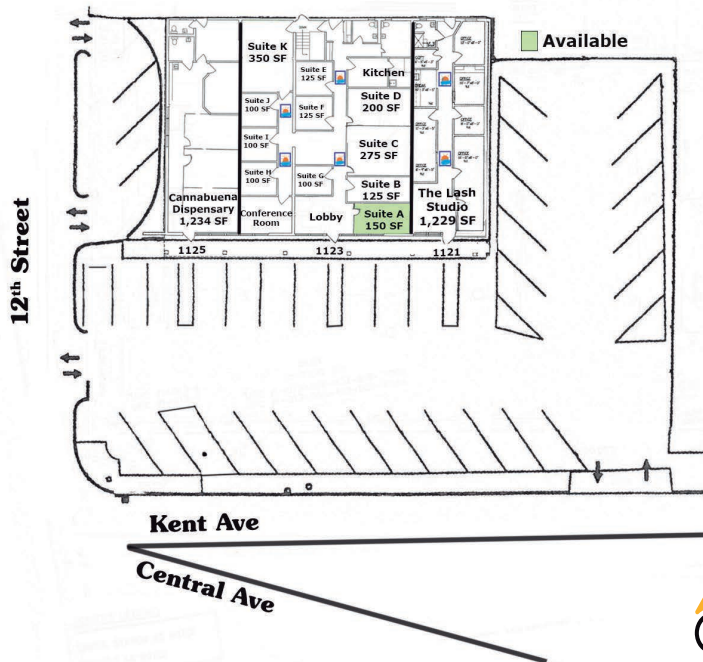

Available

- Suite 1123A | 150 SF | \$300/Mo

Please contact us for leasing opportunities

Aerial Map

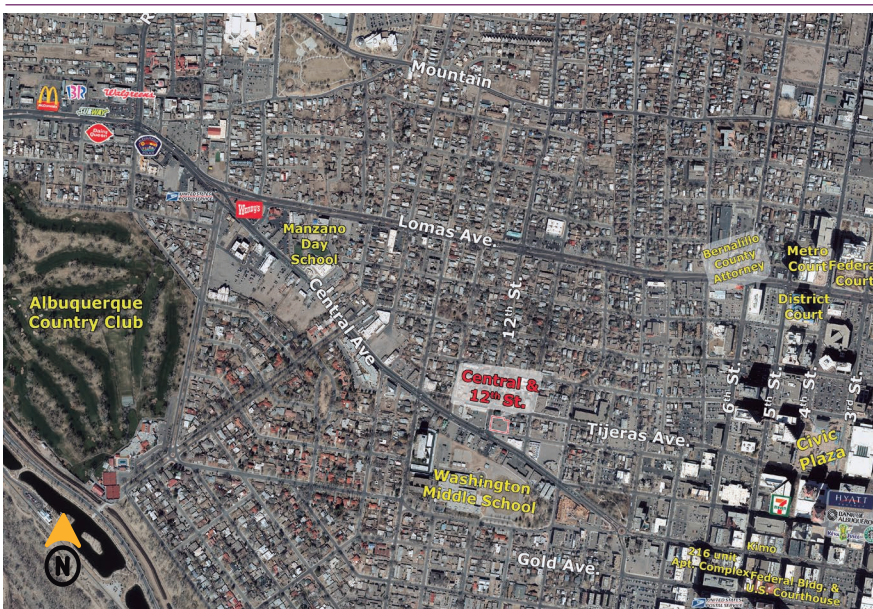

1121, 1123 & 1125 Kent Ave. NW Albuquerque, NM



Contact us



Brighton Pope | 505.884.3578 | Brighton.Pope@PetersonProperties.net

