



Juan Tabo/Candelaria

Financial Branch or Retail/ Restaurant Space for Lease

Albuquerque, NM - Northeast Heights

3201 Juan Tabo Blvd. NE



Population	17,138	120,651	313,836
Med. Income	\$36,622	\$41,770	\$47,623
Day Population	5,628	93,549	212,330

Please contact us for leasing opportunities

Available

- Entire Building | 8,380 SF | \$16,000/Month
- Financial Branch with Drive-Thru or Retail/Restaurant

Surroundings Info

- Busy Northeast Heights Area.
- Drive-Thru access.
- Vaulted ceilings in lobby.



Contact

Vanessa Smokov
 505.884.3578
 Vanessa@PetersonProperties.net

PetersonProperties.net
 /petersonpropertiesllc
 /petersonpropertiesllc
 /peterson.properties



Juan Tabo/Candelaria

Financial Branch or Retail/Restaurant Space for Lease

Site Plan

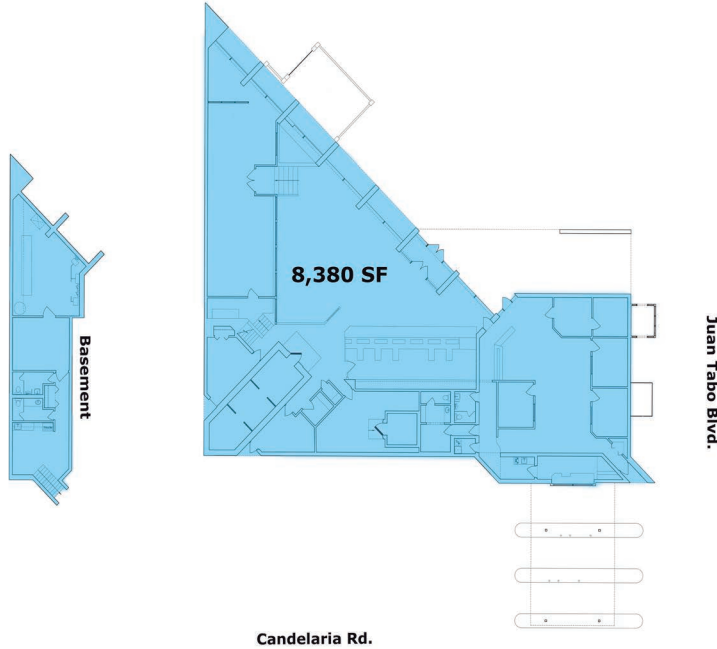

Please contact us for leasing opportunities

Aerial Map

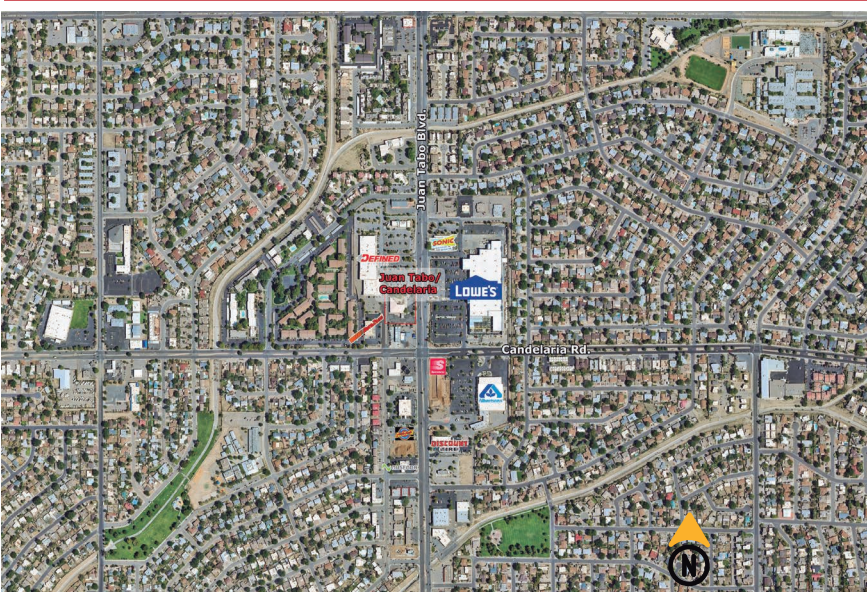

3201 Juan Tabo Blvd. NE
Albuquerque, NM

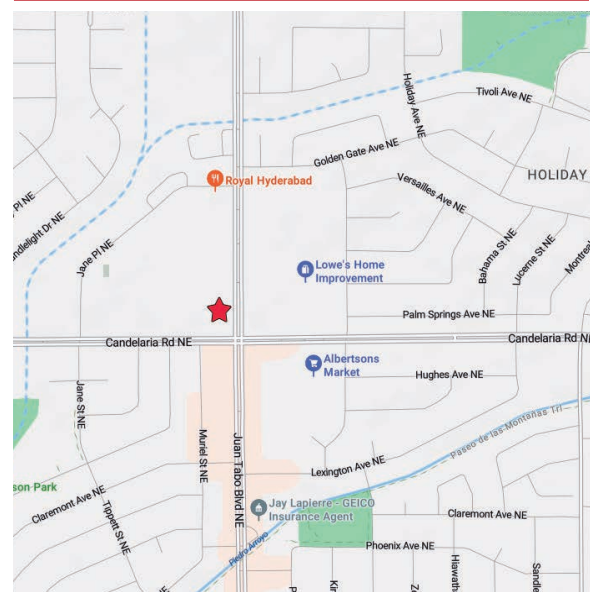

Contact us



Vanessa Smokov

505.884.3578

Vanessa@PetersonProperties.net

