



5901 Menaul NE

Financial Branch with Dive-Thru
New Retail/ Restaurant Building for Lease

Albuquerque
Northwest corner of Menaul & San Pedro



 Demographics	1 Mile	3 mile	5 mile
Population	13,662	148,889	318,784
Med. Income	\$45,489	\$41,296	\$43,655
Day Population	15,005	88,770	234,281

Please contact us for leasing opportunities

Available



- 4,745 SF with Drive-Thru | \$195,000/year
- New Retail/ Restaurant Building
- Can be occupied 9/1/29

Surroundings Info

- High profile hard corner across from Coronado Mall.
- Excellent visibility and accessibility.
- Next to Walgreens & across the street from Staples, McDonalds & Wells Fargo.



Contact

 Vanessa Smokov
 505.884.3578
 Vanessa@PetersonProperties.net

 PetersonProperties.net
 /petersonpropertiesllc
 /petersonpropertiesllc
 /peterson.properties



Site Plan

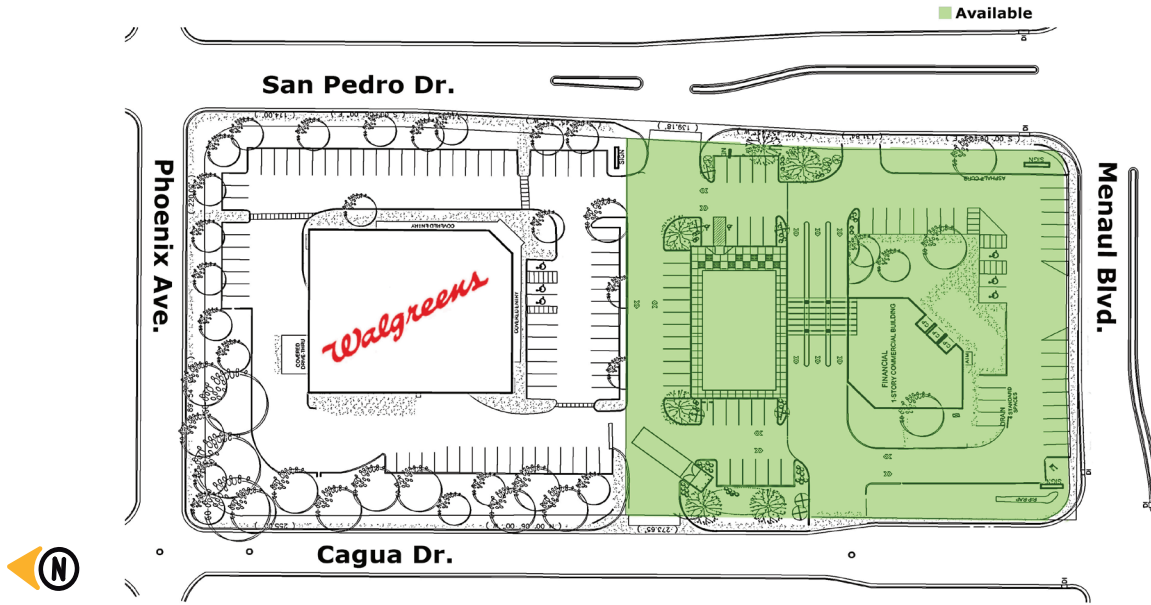

Please contact us for leasing opportunities



Aerial Map



Northwest corner of Menaul Blvd. & San Pedro Dr. NE , Albuquerque, NM

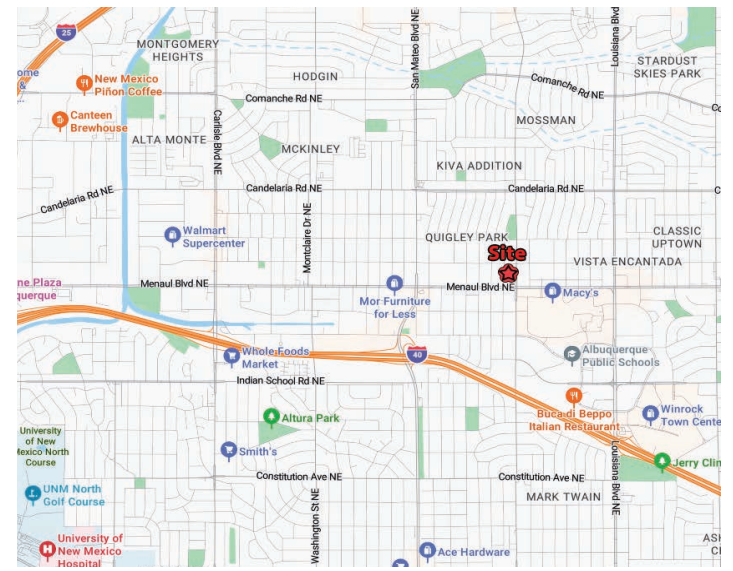

Contact us
 Vanessa Smokov | 505.884.3578 | Vanessa@PetersonProperties.net

